

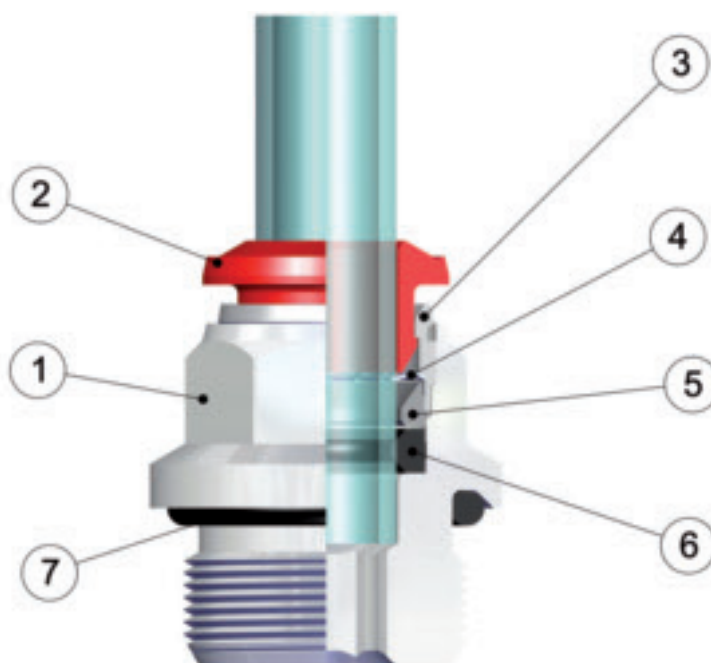

Serie 50000

RACORDAJE AUTOMÁTICO
PUSH-IN FITTINGS

Características técnicas / Technical Characteristics



Materiales y componentes / Component Parts and Materials

1 Cuerpo en latón niquelado	1 Nickel-plated brass Body
2 Anillo de extracción tubo en resina acetálica	2 Acetalic resin Collet
3 Cápsula en latón niquelado	3 Nickel-plated brass Capsule
4 Pinza de agarre en acero inox aisi 301	4 Steel aisi 301 Clamping washer
5 Anillo de seguridad en tecnopolímero	5 Technopolymeric Safety ring
6 Junta de labio en NBR	6 Nbr Lip seal
7 Junta rosca en NBR	7 Nbr Thread packing

Presiones / Pressures

Presión mínima / Minimum pressure: **-0.99 bar** (-0.099 MPa)
 Presión máxima / Maximum pressure: **15 bar** (1.5 MPa)

Temperaturas / Temperatures

Temperatura mínima / Minimum temperature: **-20 °C**
 Temperatura máxima / Maximum temperature: **+80 °C**

Roscas / Threads

Gas cónica "short" / "Short" Tapered thread.
 Gas cónica conforme ISO 7.1, BS 21, DIN 2999 / Tapered gas in conformity with ISO7.1, BS 21, DIN 2999.
 Gas cilíndrica conforme ISO 228 Clase A / Parallel gas in conformity with ISO 228 Class A.
 Métrica conforme ISO R/262 / Metric in conformity with ISO R/262.

Tubos de conexión / Connection Tubes

Tubos en material plástico:
 PA6, PA11, PA 12, Polietileno, *Poliuretano; etc.
 *Para tubos en poliuretano es aconsejada una dureza de 98 shore.
 Plastic tubes:
 PA6, PA11, PA12, Polyethylene, *Polyurethane, ecc.
 *For Polyurethane hoses it is required a minimum hardness of 98 shore.

Fluidos compatibles / Fluids

Aire comprimido / Compressed air.
 Vacío / Vacuum

Rosca / Threads

La rosca cónica "short" ha sido proyectada para satisfacer las siguientes características:

- reducir la longitud
- reducir la llave respecto a algunos racores con rosca cilíndrica
- consentir el acoplamiento con diferentes standard de roscas hembra sean cónicas o cilíndricas

The "short" taper thread has been designed to offer the following advantages to the users:

- reduced overall length;
- smaller hex dimensions compared to the parallel threads;
- to allow the assembly with different female threads both taper as well as parallel;



Consentir una completa estanqueidad incluso en superficies no perfectamente planas, cóncavas, convexas o inclinadas, con diferentes ángulos o radios.
To ensure the right tightening also with surfaces not perfectly flat, without spot-facing, concave convex and with different kinds of chamfers or radius.



Inclinada
Inclined



Cóncava
Concave



Convexa
Convex

Par de apriete / Torque specifications



PAR DE APRIETE PARA ROSCAS MACHO ISO 228 CON TÓRICA
TORQUE TO MALE THREADS ISO-228 WITH OR

MEDIDA MEASURE	PAR ACONSEJADO Nm RECOMMENDED TORQUE Nm	PAR DE ROTURA Nm BREAKING TORQUE Nm
M5	0,08	0,32
1/8	3	8
1/4	9	30
3/8	10	60
1/2	12	50

LOS VALORES DE ROTURA PUEDEN VARIAR EN FUNCIÓN DEL ARTÍCULO
BREAKING VALUES MAY VARY ACCORDING TO THE ITEM



PAR DE APRIETE PARA ROSCAS MACHO "SHORT"
TORQUE TO MALE THREADS "SHORT"

MEDIDA MEASURE	PAR MÍNIMO ACONSEJADO Nm RECOMMENDED MINIMUM TORQUE Nm	PAR MÁXIMO ACONSEJADO Nm RECOMMENDED MAX TORQUE Nm
1/8	5	7
1/4	5	7
3/8	5	7
1/2	5	7

LOS VALORES DE ROTURA PUEDEN VARIAR EN FUNCIÓN DEL ARTÍCULO
BREAKING VALUES MAY VARY ACCORDING TO THE ITEM

Todas las roscas de esta serie (incluyendo la medida de M5) están fabricadas con junta de cierre que permite la inmediata utilización del racor reduciendo notablemente el tiempo de instalación.

All of threads from this range (also the M5), have been equipped with tightening parts which allow the direct assembly of the fittings, reducing the installation time.

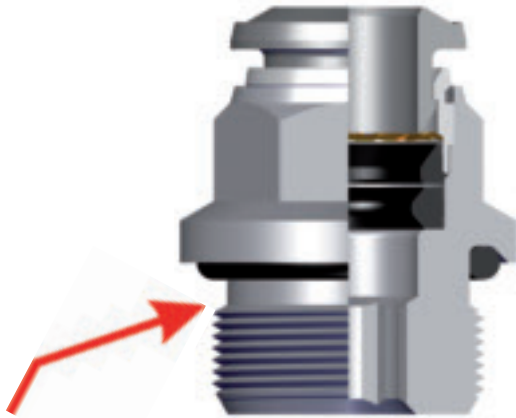

**Junta tórica (O-Ring)
para roscas cilíndricas**
*O-Ring for the parallel
threads.*

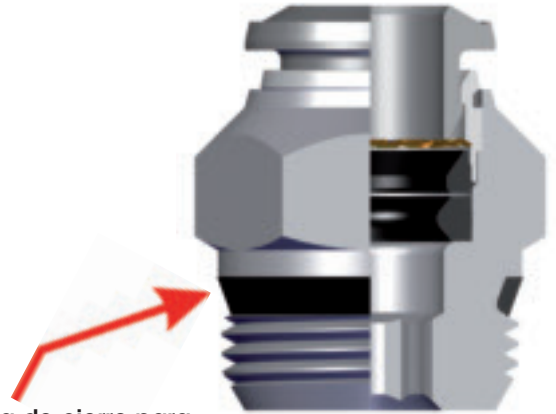

**Junta de cierre para
roscas cónicas "short"**
*Thread packing for the
taper threads.*



Todos los racores rectos, con roscas cónicas o cilíndricas, pueden montarse también con llave hexagonal y es posible utilizarlos incluso en espacios muy reducidos.

All the straight fittings, with taper and parallel threads can be assembled also with Allen wrench and it is possible to use them in reduced spaces.

Pinza de sujeción / Clamping washer

La pinza en acero inox garantiza el perfecto agarre del tubo de cualquier material sin perjudicar la superficie.

The collet made in stainless steel ensure the perfect tube clamping with every kinds of materials without damage the surface.

La conexión entre tubo y racor asegura una estanqueidad total aun en condiciones de impacto o vibración.

The connection between the tube and the fitting ensure a total tightness even in severe conditions such as impact and vibrations.

La particular geometría de la junta garantiza una perfecta estanqueidad incluso en vacío.

The particular geometric shape of the seal ensure the perfect tightness even with vacuum.

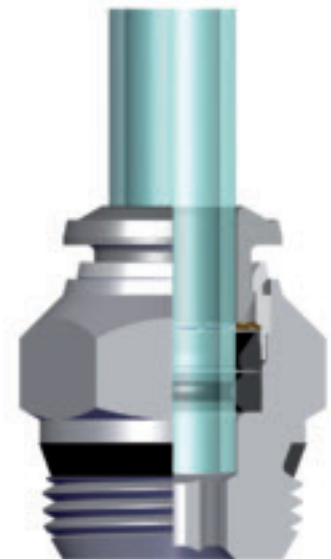

50000

RACOR RECTO MACHO CÓNICO (SHORT) - STRAIGHT MALE ADAPTOR (SHORT)

Código Code	Tubo Tube	A	B	L	CH1	CH2	Conf. Pack.
500000001	4	1/8	5.5	18	11	3	10
500000013	4	1/4	7	19	14	3	10
500000011	5	1/8	5.5	20	11	4	10
500000012	5	1/4	7	20	14	4	10
500000002	6	1/8	5.5	21.5	13	4	10
500000003	6	1/4	7	21	14	4	10
500000014	6	3/8	7.5	23	17	4	10
500000015	6	1/2	9	23.5	21	4	10
500000004	8	1/8	5.5	24.5	14	5	10
500000005	8	1/4	7	22	14	6	10
500000006	8	3/8	7.5	23	17	6	10
500000016	8	1/2	9	23.5	21	6	10
500000007	10	1/4	7	28	17	7	10
500000008	10	3/8	7.5	25.5	17	8	10
500000017	10	1/2	9	26	21	8	10
500000009	12	1/4	7	31.5	20	7	10
500000010	12	3/8	7.5	29.5	20	9	10
500000018	12	1/2	9	31.5	21	10	10
500000019	14	3/8	7.5	32.5	21	9	10
500000020	14	1/2	9	31.5	21	10	10

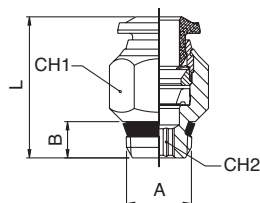

50010

RACOR RECTO MACHO CÓNICO (SHORT) HEXÁGONO INTERIOR - STRAIGHT MALE ADAPTOR (SHORT) WITH EXAGON EMBEDDED

Código Code	Tubo Tube	A	B	C	L	CH	Conf. Pack.
500100008	3	M5	4	8	19	2.5	10
500100001	4	M5	4	9.5	19.5	2.5	10
500100002	4	1/8	5.5	11	18	3	10
500100009	4	M7x1	5	10	21	2.5	10
500100007	6	M5	4	12	24.5	2.5	10
500100003	6	1/8	5.5	12	21.5	4	10
500100004	6	1/4	7	14	21	4	10
500100005	8	1/8	5.5	14	25	5	10
500100006	8	1/4	7	14	22.5	6	10

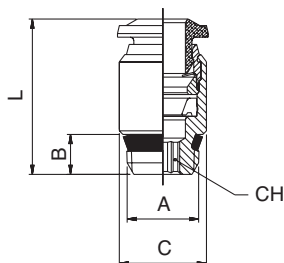

50020

RACOR RECTO MACHO CILÍNDRICO CON TÓRICA - STRAIGHT MALE ADAPTOR (PARALLEL)

Código Code	Tubo Tube	A	B	C	L	CH1	CH2	Conf. Pack.
500200021	3	M5	4	8	19	8	2	10
500200001	4	M5	4	8	21	10	2	10
500200002	4	1/8	6	13	20	10	3	10
500200022	4	1/4	8	16	19.5	16	3	10
500200018	5	M5	4	8	23.5	12	2	10
500200019	5	1/8	6	13	22	12	4	10
500200020	6	M5	4	10	24.5	13	2	10
500200003	6	1/8	6	13	23.5	13	4	10
500200004	6	1/4	8	16	23.5	13	4	10
500200027	6	3/8	9	20	25	13	4	10
500200028	6	1/2	10	25	27	13	4	10
500200005	8	1/8	6	13	25	14	5	10
500200006	8	1/4	8	16	23	14	6	10
500200007	8	3/8	9	20	24	14	6	10
500200029	8	1/2	10	25	26.5	14	6	10
500200008	10	1/4	8	16	30.5	17	6	10
500200009	10	3/8	9	20	27.5	17	8	10
500200031	10	1/2	10	25	27	17	8	10
500200032	12	1/4	8	16	34.5	20	6	10
500200011	12	3/8	9	20	34	20	8	10
500200023	12	1/2	10	25	31	22	10	10
500200024	14	3/8	9	20	35	21	10	10
500200025	14	1/2	10	25	32	22	10	10
500200012	6	M12x1	8	15	23.5	13	4	10
500200013	6	M12x1.25	8	15	23.5	13	4	10
500200014	6	M12x1.5	8	15	23.5	13	4	10
500200017	8	M12x1.5	8	15	27.5	14	6	10

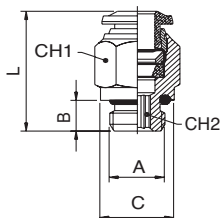

50030

RACOR RECTO HEMBRA - STRAIGHT FEMALE ADAPTOR

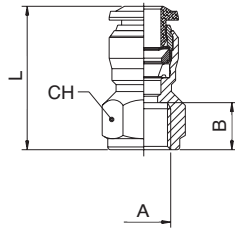

Código Code	Tubo Tube	A	B	L	CH	Conf. Pack.
500300007	3	M5	5.5	18.5	9	10
500300008	4	M5	5.5	21	11	10
500300001	4	1/8	8.5	24	13	10
500300009	4	1/4	11	27.5	16	10
500300006	5	1/8	8.5	26.5	13	10
500300002	6	1/8	8.5	26	13	10
500300003	6	1/4	11	29.5	16	10
500300004	8	1/8	8.5	27	15	10
500300005	8	1/4	11	29.5	17	10
500300010	8	3/8	12	32	19	10
500300011	10	1/4	11	32	18	10
500300012	10	3/8	12	33.5	19	10
500300013	10	1/2	15	39	24	10
500300014	12	3/8	12	36	21	10
500300015	12	1/2	15	41	24	10

50040

RACOR RECTO INTERMEDIO - STRAIGHT CONNECTOR

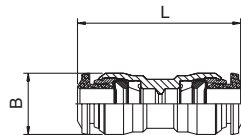

Código Code	Tubo Tube	L	B	Conf. Pack.	
500400009	3	26	8.5	10	
500400001	4	30.5	10.5	10	
500400008	5	33	11.5	10	
500400002	6	4	32	12.5	10
500400003	6	34	12.5	10	
500400004	8	6	35	14.5	10
500400005	8	36	14.5	10	
500400011	10	8	40.5	17.5	10
500400006	10	42	17.5	10	
500400012	12	10	45.5	20.5	10
500400007	12	47	20.5	10	
500400010	14	49	21.5	10	

50050

RACOR RECTO INTERMEDIO PASATABIQUES - BULKHEAD CONNECTOR

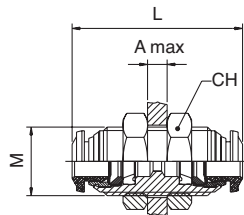

Código Code	Tubo Tube	M	L	CH	A max	Conf. Pack.
500500007	3	M10x1	26	14	5	10
500500001	4	M12x1	31.5	17	7	10
500500006	5	M14x1	33	17	7	10
500500002	6	M14x1	35	17	9.5	10
500500003	8	M16x1	37	19	10.5	10
500500004	10	M20x1	43	24	12.5	10
500500005	12	M22x1	48	26	16.5	10

50100

RACOR A L MACHO CÓNICO - ELBOW MALE ADAPTOR (TAPER)

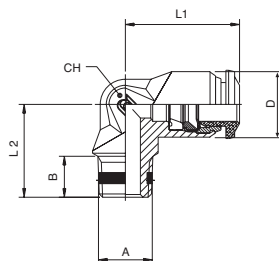

Código Code	Tubo Tube	A	B	L1	L2	CH	D	Conf. Pack.
501000001	4	M5	5	17	15	9	10	10
501000002	4	1/8	7.5	17	15.5	9	10	10
501000010	5	M5	5	20	17	11	12.5	10
501000011	5	1/8	7.5	20	17.5	11	12.5	10
501000003	6	1/8	7.5	21	17.5	11	12.5	10
501000012	6	1/4	11	21	21.5	11	12.5	10
501000004	8	1/8	7.5	22.5	19	13	14	10
501000005	8	1/4	11	22.5	21.5	13	14	10
501000006	10	1/4	11	26.5	24.5	16	17	10
501000007	10	3/8	11.5	26.5	24	16	17	10
501000008	12	1/4	11	30.5	28	19	21.5	10
501000009	12	3/8	11.5	30.5	28	19	21.5	10

50106

RACOR A L ORIENTABLE HEMBRA - ORIENTING ELBOW FEMALE ADAPTOR

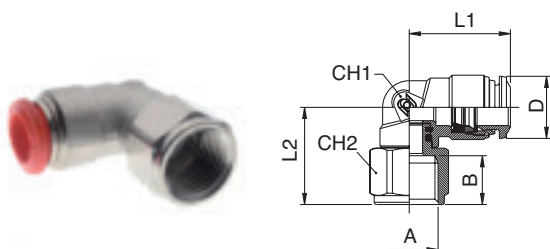

Código Code	Tubo Tube	A	B	L1	L2	CH1	CH2	D	Conf. Pack.
501060001	4	- 1/8	8.5	18	20	9	13	10	10
501060002	4	- 1/4	11	18	21.5	9	16	10	10
501060003	6	- 1/8	8.5	21	20.5	11	13	12.5	10
501060004	6	- 1/4	11	21	23	11	16	12.5	10
501060005	8	- 1/8	8.5	22.5	22	12	13	14.5	10
501060006	8	- 1/4	11	22.5	24.5	12	16	14.5	10

50111

RACOR A L ORIENTABLE MACHO CÓNICO (SHORT) - ORIENTING ELBOW MALE ADAPTOR (SHORT)

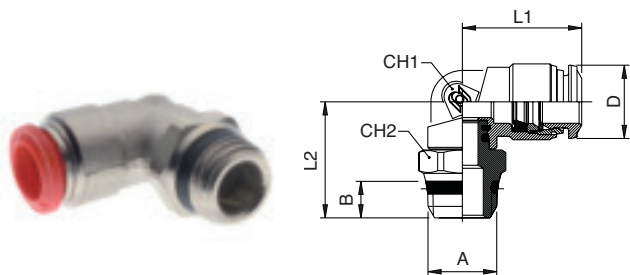

Código Code	Tubo Tube	A	B	L1	L2	CH	CH2	D	Conf. Pack.
501110001	4	1/8	5.5	18	19.5	9	13	10	10
501110002	4	1/4	7	18	21	9	15	10	10
501110003	5	1/8	5.5	20	21.5	11	13	12.5	10
501110004	6	1/8	5.5	21	21.5	11	13	12.5	10
501110005	6	1/4	7	21	23	11	15	12.5	10
501110006	8	1/8	5.5	22.5	24	12	13	14.5	10
501110007	8	1/4	7	22.5	24	12	15	14.5	10
501110008	8	3/8	7.5	22.5	24.5	12	17	14.5	10
501110009	8	1/2	9	22.5	27	12	21	14.5	10
501110010	10	1/4	7	26.5	26.5	14	16	17.5	10
501110011	10	3/8	7.5	26.5	24.5	14	17	17.5	10
501110012	10	1/2	9	26.5	27	14	21	17.5	10
501110013	12	3/8	7.5	31.5	26.5	16	20	21.5	10
501110014	12	1/2	9	31.5	29	16	21	21.5	10
501110015	14	3/8	7.5	31.5	27	16	20	21.5	10
501110016	14	1/2	9	31.5	29.5	16	21	21.5	10

50116

RACOR A L ORIENTABLE MACHO CILÍNDRICO CON TÓRICA - ORIENTING ELBOW MALE ADAPTOR (PARALLEL)

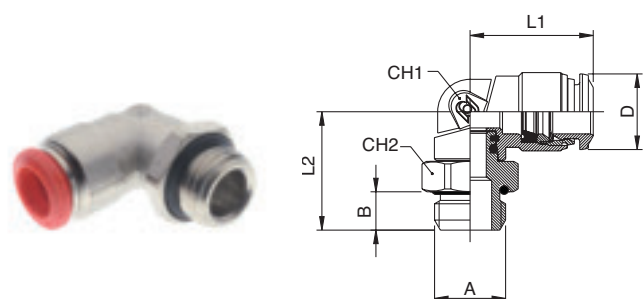

Código Code	Tubo Tube	A	B	L1	L2	CH1	CH2	D	Conf. Pack.
501160001	3	M5	3.5	16.5	17.5	9	8	10	10
501160002	4	M5	3.5	18	17.5	9	8	10	10
501160003	4	1/8	5.5	18	18	9	13	10	10
501160004	4	1/4	7	18	18	9	16	10	10
501160005	5	M5	3.5	20	20	11	11	12.5	10
501160006	5	1/8	5.5	20	20	11	13	12.5	10
501160007	6	M5	3.5	21	20	11	11	12.5	10
501160008	6	1/8	5.5	21	20	11	13	12.5	10
501160009	6	1/4	7	21	21.5	11	16	12.5	10
501160010	8	1/8	5.5	22.5	22.5	12	13	14.5	10
501160011	8	1/4	7	22.5	23	12	16	14.5	10
501160012	8	3/8	8	22.5	25	12	20	14.5	25
501160013	8	1/2	9.5	22.5	26.5	12	25	14.5	10
501160014	10	1/4	7	26.5	25.5	14	16	17.5	10
501160015	10	3/8	8	26.5	25	14	20	17.5	10
501160016	10	1/2	9.5	26.5	26.5	14	25	17.5	10
501160025	12	1/4	8	31.5	27.5	16	20	21.5	10
501160017	12	3/8	8	31.5	27	16	20	21.5	10
501160018	12	1/2	9.5	31.5	28.5	16	25	21.5	10
501160019	14	3/8	8	31.5	27.5	16	20	21.5	10
501160020	14	1/2	9.5	31.5	29	16	25	21.5	10
501160021	6	M12x1	7.5	20	22	11	16	12.5	10
501160022	6	M12x1.25	7.5	20	22	11	16	12.5	10
501160023	6	M12x1.5	7.5	20	22	11	16	12.5	10
501160024	8	M12x1.5	7.5	22.5	23.5	12	16	14.5	10

50121

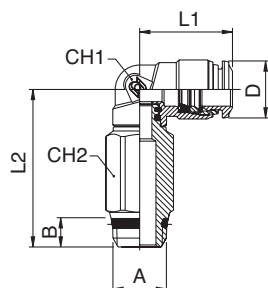
RACOR A L ORIENTABLE PROLONGADO MACHO CÓNICO (SHORT) - EXTENDED ORIENTING ELBOW MALE ADAPTOR (SHORT)

Código Code	Tubo Tube	A	B	L1	L2	CH1	CH2	D	Conf. Pack.
5012100001	4	1/8	5.5	18	31.5	9	12	10	10
5012100002	4	1/4	7	18	33	9	15	10	10
5012100003	5	1/8	5.5	20	36	11	12	12.5	10
5012100004	6	1/8	5.5	21	36	11	12	12.5	10
5012100005	6	1/4	7	21	37.5	11	15	12.5	10
5012100006	8	1/8	5.5	22.5	40.5	12	12	14.5	10
5012100007	8	1/4	7	22.5	40.5	12	15	14.5	10
5012100008	8	3/8	7.5	22.5	41	12	16	14.5	10
5012100009	10	1/4	7	26.5	46	14	15	17.5	10
5012100010	10	3/8	7.5	26.5	44	14	17	17.5	10

50126

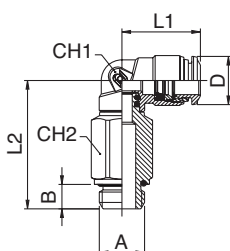
RACOR A L ORIENTABLE PROLONGADO MACHO CILÍNDRICO CON TÓRICA - EXTENDED ORIENTING ELBOW MALE ADAPTOR (PARALLEL)

Código Code	Tubo Tube	A	B	L1	L2	CH1	CH2	D	Conf. Pack.
5012600001	4	1/8	5.5	18	30	9	12	10	10
5012600002	4	1/4	7	18	32	9	15	10	10
5012600003	5	1/8	5.5	20	34.5	11	12	12.5	10
5012600004	6	1/8	5.5	21	34.5	11	12	12.5	10
5012600005	6	1/4	7	21	36	11	15	12.5	10
5012600006	8	1/8	5	23	39	12	12	14.5	10
5012600007	8	1/4	7	22.5	39.5	12	15	14.5	10
5012600008	8	3/8	8	22.5	41.5	12	18	14.5	10
5012600009	10	1/4	7	26.5	45	14	16	17.5	10
5012600010	10	3/8	8	26.5	44.5	14	18	17.5	10

50130

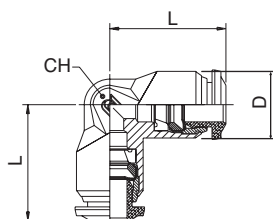
RACOR A L INTERMEDIO - ELBOW CONNECTOR

Código Code	Tubo Tube	L	CH	D	Conf. Pack.
5013000007	3	17	9	10	10
5013000001	4	17	9	10	10
5013000006	5	20	11	12.5	10
5013000002	6	21	11	12.5	10
5013000003	8	22.5	13	14	10
5013000004	10	26.5	16	17	10
5013000005	12	30.5	19	21.5	10
5013000008	14	32.5	19	21.5	10

50200

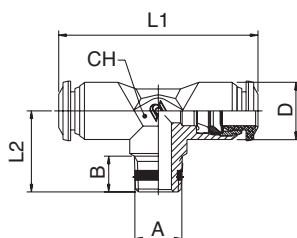
RACOR A T MACHO CENTRAL CÓNICO - TEE MALE ADAPTOR (TAPER) - CENTRE LEG

Código Code	Tubo Tube	A	B	L1	L2	CH	D	Conf. Pack.
5020000001	4 - M5	5	34	15	9	10	10	10
5020000002	4 - 1/8	7.5	34	15.5	9	10	10	10
5020000010	5 - 1/8	7.5	40	17.5	11	12.5	10	10
5020000003	6 - 1/8	7.5	42	17.5	11	12.5	10	10
5020000004	8 - 1/8	7.5	45	19	13	14	10	10
5020000005	8 - 1/4	11	45	21.5	13	14	10	10
5020000006	10 - 1/4	11	53	24.5	16	17	10	10
5020000007	10 - 3/8	11.5	53	24	16	17	10	10
5020000008	12 - 1/4	11	61	28	19	21.5	10	10
5020000009	12 - 3/8	11.5	61	28	19	21.5	10	10

50211

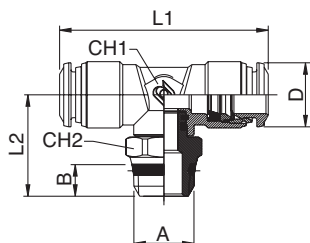
RACOR A T ORIENTABLE MACHO CENTRAL CÓNICO (SHORT) - ORIENTING TEE MALE ADAPTOR (SHORT) - CENTRE LEG

Código Code	Tubo Tube	A	B	L1	L2	CH1	CH2	D	Conf. Pack.
5021100001	4	1/8	5.5	34	20	9	13	10	10
5021100002	4	1/4	7	34	21.5	9	15	10	10
5021100003	5	1/8	5.5	40	22	11	13	12.5	10
5021100004	6	1/8	5.5	42	22	11	13	12.5	10
5021100005	6	1/4	7	42	23.5	11	15	12.5	10
5021100006	8	1/8	5.5	45	25.5	13	13	14.5	10
5021100007	8	1/4	7	45	25.5	13	15	14.5	10
5021100008	8	3/8	7.5	45	26	13	17	14.5	10
5021100009	8	1/2	9	45	28.5	13	21	14.5	10
5021100010	10	1/4	7	53	29	14	16	17.5	10
5021100011	10	3/8	7.5	53	27	14	17	17.5	10
5021100012	10	1/2	9	53	29.5	14	21	17.5	10
5021100013	12	3/8	7.5	62.6	29.5	16	20	21.5	10
5021100014	12	1/2	9	62.6	32	16	21	21.5	10
5021100015	14	3/8	7.5	62.6	29.5	16	20	21.5	10
5021100016	14	1/2	9	62.6	32	16	21	21.5	10

50216

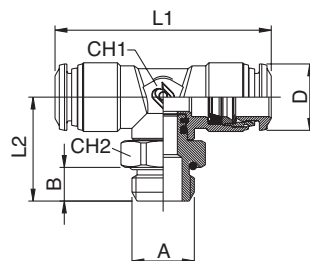
RACOR A T ORIENTABLE MACHO CENTRAL CILÍNDRICO CON TÓRICA - ORIENTING TEE MALE ADAPTOR (PARALLEL) - CENTRE LEG

Código Code	Tubo Tube	A	B	L1	L2	CH1	CH2	D	Conf. Pack.
5021600001	3	M5	3.5	33	17	9	8	10	10
5021600002	4	M5	3.5	34	18	9	8	10	10
5021600003	4	1/8	5.5	34	18.5	9	13	10	10
5021600004	4	1/4	7	34	20	9	16	10	10
5021600005	5	M5	3.5	40	20.5	11	11	12.5	10
5021600006	5	1/8	5.5	40	20.5	11	13	12.5	10
5021600007	6	M5	3.5	42	20.5	11	11	12.5	10
5021600008	6	1/8	5.5	42	20.5	11	13	12.5	10
5021600009	6	1/4	7	42	22	11	16	12.5	10
5021600010	8	1/8	5.5	45	23.5	13	13	14.5	10
5021600011	8	1/4	7	45	24	13	16	14.5	10
5021600012	8	3/8	8	45	26	13	20	14.5	10
5021600013	8	1/2	9.5	45	27.5	13	25	14.5	10
5021600014	10	1/4	7	53	27.5	14	16	17.5	10
5021600015	10	3/8	8	53	27	14	20	17.5	10
5021600016	10	1/2	9.5	53	28.5	14	25	17.5	10
5021600017	12	3/8	8	62.5	29.5	16	20	21.5	10
5021600018	12	1/2	9.5	62.5	31	16	25	21.5	10
5021600019	14	3/8	8	62.5	29.5	16	20	21.5	10
5021600020	14	1/2	9.5	62.5	31	16	25	21.5	10
5021600021	6	M12x1	7.5	42	22	11	16	12.5	10
5021600022	6	M12x1.25	7.5	42	22	11	16	12.5	10
5021600023	6	M12x1.5	7.5	42	22	11	16	12.5	10

50223

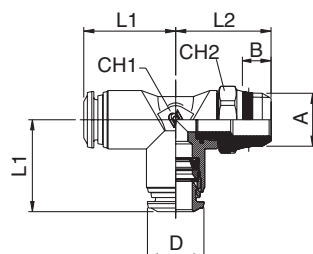
RACOR A T ORIENTABLE MACHO LATERAL CÓNICO (SHORT) - ORIENTING TEE MALE ADAPTOR (SHORT) OFF - SET LEG

Código Code	Tubo Tube	A	B	L1	L2	CH1	CH2	D	Conf. Pack.
5022300001	4	1/8	5.5	17	20	9	13	10	10
5022300002	4	1/4	7	17	21.5	9	15	10	10
5022300003	5	1/8	5.5	20	22	11	13	12.5	10
5022300004	6	1/8	5.5	21	22	11	13	12.5	10
5022300005	6	1/4	7	21	23.5	11	15	12.5	10
5022300006	8	1/8	5.5	22.5	25	13	13	14.5	10
5022300007	8	1/4	7	22.5	25	13	15	14.5	10
5022300008	8	3/8	7.5	22.5	28	13	17	14.5	10
5022300009	8	1/2	9	22.5	28	13	21	14.5	10
5022300010	10	1/4	7	26.5	26	14	16	17.5	10
5022300011	10	3/8	7.5	26.5	26	14	17	17.5	10
5022300012	10	1/2	9	26.5	28.5	14	21	17.5	10
5022300013	12	3/8	7.5	31.5	29.5	16	20	21.5	10
5022300014	12	1/2	9	31.5	32	16	21	21.5	10

50226

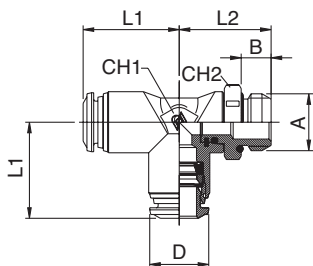
RACOR A T ORIENTABLE MACHO LATERAL CILÍNDRICO CON TÓRICA - ORIENTING TEE MALE ADAPTOR (PARALLEL) OFF - SET LEG

Código Code	Tubo Tube	A	B	L1	L2	CH1	CH2	D	Conf. Pack.
5022600001	3	M5	3.5	16.5	17	9	8	10	10
5022600002	4	M5	3.5	17	18	9	8	10	10
5022600003	4	1/8	5.5	17	18.5	9	13	10	10
5022600004	4	1/4	7	17	20	9	16	10	10
5022600005	5	M5	3.5	20	20.5	11	11	12.5	10
5022600006	5	1/8	5.5	20	20.5	11	13	12.5	10
5022600007	6	M5	3.5	21	20.5	11	11	12.5	10
5022600008	6	1/8	5.5	21	20.5	11	13	12.5	10
5022600009	6	1/4	7	21	22	11	16	12.5	10
5022600010	8	1/8	5.5	22.5	22.5	13	13	14.5	10
5022600011	8	1/4	7	22.5	24	13	16	14.5	10
5022600012	8	3/8	8	22.5	26	13	20	14.5	10
5022600013	8	1/2	9.5	22.5	27.5	13	25	14.5	10
5022600014	10	1/4	7	26.5	27	14	16	17.5	10
5022600015	10	3/8	8	26.5	26.5	14	20	17.5	10
5022600016	10	1/2	9.5	26.5	28	14	25	17.5	10
5022600017	12	3/8	8	31.5	29.5	16	20	21.5	10
5022600018	12	1/2	9.5	31.5	31	16	25	21.5	10
5022600021	6	M12x1	7.5	21	22	11	16	12.5	10
5022600022	6	M12x1.25	7.5	21	22	11	16	12.5	10
5022600023	6	M12x1.5	7.5	21	22	11	16	12.5	10

50230

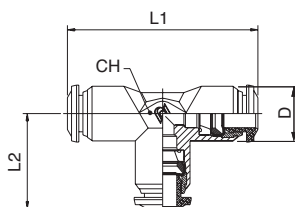
RACOR A T INTERMEDIO - TEE CONNECTOR

Código Code	Tubo Tube	L1	L2	CH	D	Conf. Pack.
5023000007	3	34	17	9	10	10
5023000001	4	34	17	9	10	10
5023000006	5	40	20	11	12.5	10
5023000002	6	42	21	11	12.5	10
5023000003	8	45	22.5	13	14	10
5023000004	10	53	26.5	16	17	10
5023000005	12	61	30.5	19	21.5	10
5023000008	14	65.5	32.5	19	21.5	10

50310

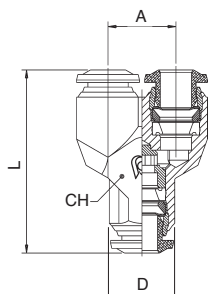
RACOR A Y INTERMEDIO - Y CONNECTOR

Código Code	Tubo Tube	A	L	CH	D	Conf. Pack.
5031000007	3	10	29	11	10	10
5031000001	4	11	32	11	10	10
5031000004	5	13.5	35	13	12.5	10
5031000002	6	13.5	36.5	13	12.5	10
5031000003	8	15.5	41	15	14	10
5031000008	10	18.5	48	18	17	10

50500

ANILLO ORIENTABLE SIMPLE - SINGLE BANJO BODY

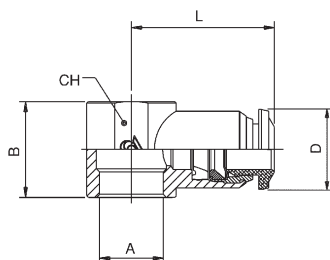

Código Code	Tubo Tube	A	B	L	CH	D	Conf. Pack.
505000019	3	M5	12.5	19	-	10	10
505000020	3	M6	12.5	19	-	10	10
505000001	4	M5	12.5	19	-	10	10
505000002	4	M6	12.5	19	-	10	10
505000003	4	1/8	15	21	14	10	10
505000013	5	M5	12.5	20	-	12.5	10
505000017	5	M6	12.5	20	-	12.5	10
505000014	5	1/8	15	21.5	14	12.5	10
505000015	5	1/4	17	24.5	18	12.5	10
505000016	6	M5	12.5	20.5	-	12.5	10
505000018	6	M6	12.5	20.5	-	12.5	10
505000004	6	1/8	15	22	14	12.5	10
505000005	6	1/4	17	25	18	12.5	10
505000006	8	1/8	15	24	14	14	10
505000007	8	1/4	17	26	18	14	10
505000008	8	3/8	20	28	21	14	10
505000009	10	1/4	17	29	18	17	10
505000010	10	3/8	20	30.5	21	17	10
505000012	12	3/8	20	32.5	21	21.5	10
505000021	12	1/2	24	35	25	21.5	10
505000022	14	1/2	24	35.5	25	21.5	10

50510

ANILLO ORIENTABLE DOBLE - DOUBLE BANJO BODY

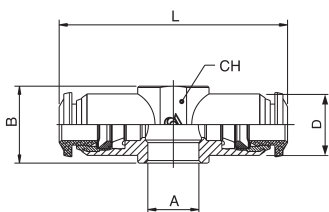

Código Code	Tubo Tube	A	B	L	CH	D	Conf. Pack.
505100001	4	M5	12.5	38	-	10	10
505100002	4	M6	12.5	38	-	10	10
505100003	4	1/8	15	42	14	10	10
505100008	5	1/8	15	43	14	12.5	10
505100009	5	1/4	17	49	18	12.5	10
505100004	6	1/8	15	44	14	12.5	10
505100005	6	1/4	17	50	18	12.5	10
505100006	8	1/8	15	48	14	14	10
505100007	8	1/4	17	52	18	14	10

50550

RACOR ORIENTABLE SIMPLE CON TÓRICA - ORIENTING SINGLE BANJO BODY MALE

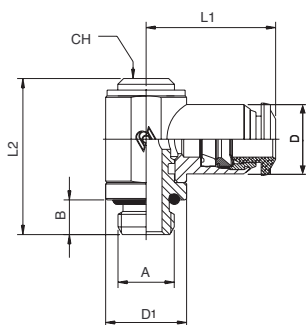

Código Code	Tubo Tube	A	B	L1	L2	CH	D1	D	Conf. Pack.
505500001	4	M5	3.6	19	24.5	-	CH8	10	10
505500002	4	1/8	6	21	28	5	14	10	10
505500012	5	M5	3.6	20	24.5	-	CH8	12.5	10
505500013	5	1/8	6	21.5	28	5	14	12.5	10
505500014	5	1/4	8	24.5	31	6	18	12.5	10
505500015	6	M5	3.6	20.5	24.5	-	CH8	12.5	10
505500003	6	1/8	6	22.5	28	5	14	12.5	10
505500004	6	1/4	8	25	31	6	18	12.5	10
505500005	8	1/8	6	24	28	5	14	14	10
505500006	8	1/4	8	26	31	6	18	14	10
505500007	8	3/8	9	28	35.5	7	21	14	10
505500008	10	1/4	8	29	31	6	18	17	10
505500009	10	3/8	9	30.5	35.5	7	21	17	10
505500011	12	3/8	9	32.5	35.5	7	21	21.5	10

50560

RACOR ORIENTABLE DOBLE CON TÓRICA - ORIENTING DOUBLE BANJO BODY MALE

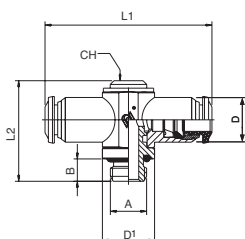

Código Code	Tubo Tube	A	B	L1	L2	D1	CH	D	Conf. Pack.
505600002	4	1/8	6	42	27	14	5	10	10
505600008	5	1/8	6	43	27	14	5	12.5	10
505600009	5	1/4	8	49	31	18	6	12.5	10
505600003	6	1/8	6	45	27	14	5	12.5	10
505600004	6	1/4	8	50	31	18	6	12.5	10
505600005	8	1/8	6	48	27	14	5	14	10
505600006	8	1/4	8	52	31	18	6	14	10

51410

TORNILLO SIMPLE - BANJO STEM SINGLE

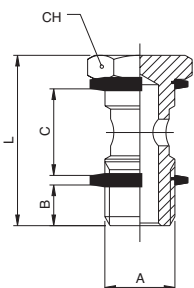

Código Code	A	B	C	L	CH	Conf. Pack.
5141000011	M5	4	12.5	22	8	25
5141000012	M6	5	12.5	23	8	25
5141000013	1/8	6	15	28	14	25
5141000014	1/4	8	17	32	17	25
5141000015	3/8	9	20	36	19	25
5141000016	1/2	10	24	42	24	25
5141000017	*M12x1.5	8	17	32	17	25

ESTE ARTÍCULO VIENE COMPLETO DE ARANDELAS EN NYLON (ART.1610).
THIS ITEM WILL BE SUPPLIED WITH THE NYLON WASHERS (ART. 1610).

*CON ESTE TORNILLO UTILIZAR EL ANILLO ORIENTABLE DE 1/4.
*WITH THIS BANJO STEM USING 1/4 ORIENTING BANJO BODY.

51420

TORNILLO DOBLE - BANJO STEM DOUBLE

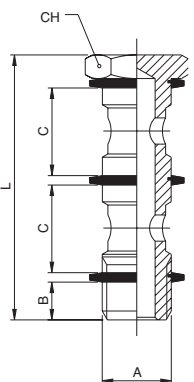

Código Code	A	B	C	L	CH	Conf. Pack.
5142000011	1/8	6	15	44.5	14	25
5142000012	1/4	8	17	50.5	17	25
5142000013	3/8	9	20	58	19	25
5142000014	1/2	10	24	68	24	25
5142000015	*M12x1.5	8	17	50.5	17	25

ESTE ARTÍCULO VIENE COMPLETO DE ARANDELAS EN NYLON (ART.1610).
THIS ITEM WILL BE SUPPLIED WITH THE NYLON WASHERS (ART. 1610).

*CON ESTE TORNILLO UTILIZAR EL ANILLO ORIENTABLE DE 1/4.
*WITH THIS BANJO STEM USING 1/4 ORIENTING BANJO BODY.

51430

TORNILLO TRIPLE - BANJO STEM TRIPLE

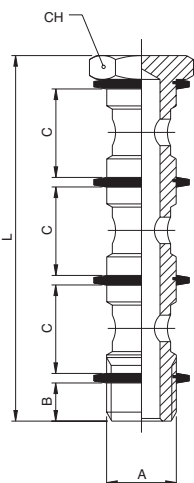

Código Code	A	B	C	L	CH	Conf. Pack.
5143000011	1/8	6	15	61	14	25
5143000012	1/4	8	17	69	17	25
5143000013	3/8	9	20	80	19	25
5143000014	1/2	10	24	94	24	10

ESTE ARTÍCULO VIENE COMPLETO DE ARANDELAS EN NYLON (ART.1610).
THIS ITEM WILL BE SUPPLIED WITH THE NYLON WASHERS (ART. 1610).

51440

TORNILLO SIMPLE MACHO - HEMBRA - MALE - FEMALE BANJO STEM SINGLE

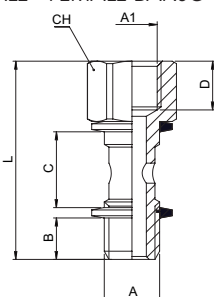

Código Code	A	A1	B	C	D	L	CH	Conf. Pack.
5144000001	1/8	1/8	6	15	8.5	34.5	14	25
5144000002	1/4	1/4	8	17	11	40.5	17	25
5144000003	3/8	3/8	9	20	12	45.5	19	25

ESTE ARTÍCULO VIENE COMPLETO DE ARANDELAS EN NYLON (ART.1610).
THIS ITEM WILL BE SUPPLIED WITH THE NYLON WASHERS (ART. 1610).

50600

ADAPTADOR MACHO CILÍNDRICO CON TÓRICA - MALE ADAPTOR PARALLEL

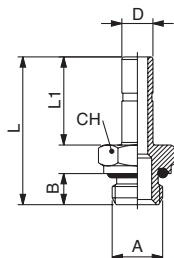

Código Code	D	A	B	L	L1	CH	Conf. Pack.
506000001	4	M5	4	24	15	8	10
506000002	4	1/8	6	26.5	15	13	10
506000012	5	M5	4	26	17	8	10
506000013	5	1/8	6	28.5	17	13	10
506000014	5	1/4	8	31	17	16	10
506000015	6	M5	4	26	17	8	10
506000003	6	1/8	6	28.5	17	13	10
506000004	6	1/4	8	31	17	16	10
506000005	8	1/8	6	29.5	18	13	10
506000006	8	1/4	8	32	18	16	10
506000007	8	3/8	9	33.5	18	20	10
506000016	10	1/8	6	33.5	22	13	10
506000008	10	1/4	8	36	22	16	10
506000009	10	3/8	9	37.5	22	20	10
506000010	12	1/4	8	38.5	24.5	16	10
506000011	12	3/8	9	40	24.5	20	10

8610

TAPÓN - PLUG

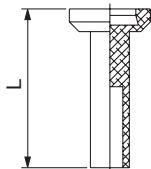

Código Code	Tubo Tube	L	Conf. Pack.
086100031X0RO	3	18	25
086100031X1RO	4	23.5	25
086100031X3RO	5	24.5	25
086100031X4RO	6	24.5	25
086100031X7RO	8	26	25
086100031X9RO	10	28.5	25
086100031Y1RO	12	28.5	25
086100031Y3RO	14	28.5	20

50625

UNIÓN DOBLE - DOUBLE JOINT

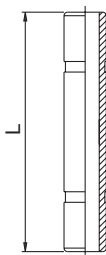

Código Code	Tubo Tube	L	Conf. Pack.
506250001X1NB	4	31	10
506250001X3NB	5	33	10
506250001X4NB	6	34	10
506250001X7NB	8	36	10
506250001X9NB	10	45	10
506250001Y1NB	12	50	10

50700

REDUCCIÓN - REDUCER

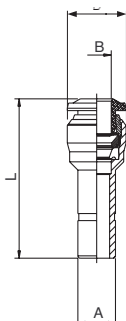

Código Code	A	B	L	D	Conf. Pack.
507000006	4	3	30	8.5	10
507000004	5	4	32	11.5	10
507000001	6	4	30	10.5	10
507000005	6	5	34.5	11.5	10
507000008	8	4	32.5	10.5	10
507000002	8	6	34.5	12.5	10
507000009	10	4	31.5	10.5	10
507000003	10	8	38.5	14.5	10
507000007	12	8	39.5	14.5	10
507000010	12	10	43	17.5	10

55800R

CARTUCHO A COMPRESIÓN - PUSH-FIT CARTRIDGES

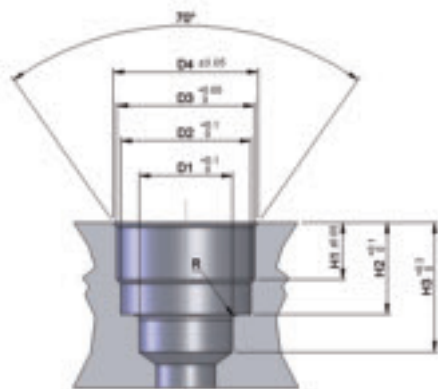
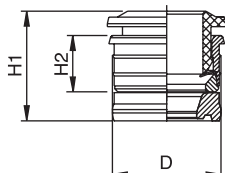

Código Code	Tubo Tube	D	H1	H2	Conf. Pack.
558000008	3	6.7	9	5	25
558000001	4	8.7	10.4	5.6	25
558000002	5	9.75	11.8	6.3	25
558000003	6	10.75	12.4	6.9	25
558000004	8	12.7	12.4	6.9	25
558000005	10	15.7	15.7	8.5	25
558000006	12	18.3	17.8	9.5	25

55800

SEDE - SEAT

DIMENSIONES SEDE CARTUCHO A COMPRESIÓN
SEATS DIMENSIONS PUSH-FIT CARTRIDGES

Tubo Tube	D1	D2	D3	D4	H1	H2	H3	R
3	3.4	6.05	6.4	6.95	3.7	6.1	8.6	0.5
4	4.2	7.45	8.4	9	3.75	6.5	9.5	0.5
5	5.2	8.35	9.4	10.15	4.45	7.9	10.5	0.5
6	6.2	9.35	10.45	11.35	5	8.5	11.5	0.5
8	8.2	11.4	12.4	12.9	5.2	8.5	12.5	0.75
10	10.2	14.5	15.4	16	6.7	10.5	15	0.75
12	12.2	17	18	19	7.5	12.1	17	1

55801

FRESA SEDE CARTUCHO A COMPRESIÓN
TOOL FOR PUSH-FIT CARTRIDGES SEAT



Código Code	Tubo Tube	Ø Cuerpo Body	Conf. Pack.
558010007	3	10	1
558010001	4	10	1
558010006	5	12	1
558010002	6	12	1
558010003	8	12	1
558010004	10	16	1
558010005	12	16	1

55802

ÚTIL DE MONTAJE CARTUCHO A COMPRESIÓN
ASSEMBLING TOOL FOR PUSH-FIT CARTRIDGES



Código Code	Tubo Tube	Conf. Pack.
558020001	3	1
558020002	4	1
558020003	5	1
558020004	6	1
558020005	8	1
558020006	10	1
558020007	12	1

INSTRUCCIONES DE MONTAJE CARTUCHO A COMPRESIÓN ART.55800R PUSH-FIT CARTRIDGES ASSEMBLING INSTRUCTIONS ART. 55800R

Realizar la sede para el cartucho utilizando la correspondiente fresa Art. 55801.

Make the seat for the cartridge utilizing the suitable tool Art. 55801.



2

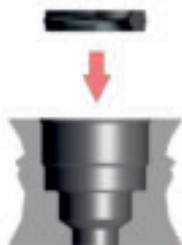

Insertar la junta de labio en la correspondiente sede.
Insert the lip seal inside of the seat.

Insertar el cartucho en el útil de montaje Art. 55802

Insert the cartridge into the assembling tool Art. 55802



3

4



Empujar el cartucho al interior de la sede hasta llegar al plano con el útil de montaje.

Press the cartridge inside of the seat until it will be reached the abutment surface with the assembling tool.

50900

REGLETA EN ALUMINIO A 5 VÍAS - ALUMINIUM MANIFOLD 5 WAYS

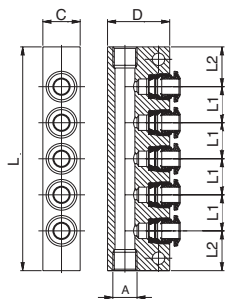

Código Code	Tubo Tube	A	C	D	L	L1	L2	Conf. Pack.
5090000001	4	1/8	15	25	75	12	13,5	5
5090000002	6	1/8	15	25	90	14,5	16	5
5090000003	6	1/4	20	30	90	14,5	16	5
5090000004	8	1/4	20	30	100	16	18	5

50990

LLAVE DE DESMONTAJE - TOOL FOR DISASSEMBLING

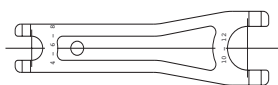

Código Code	Conf. Pack.
5099000001	10

50006

JUNTA DE CIERRE PARA ROSCAS CÓNICAS - THREAD PACKING FOR TAPER THREADS



Código Code	Rosca Thread	Conf. Pack.
5000600240200	1/8	10
5000600240300	1/4	10
5000600240400	3/8	10
5000600240500	1/2	10

